

Highway Viaduct/Rail at Grade Option – Presented 2/16/17

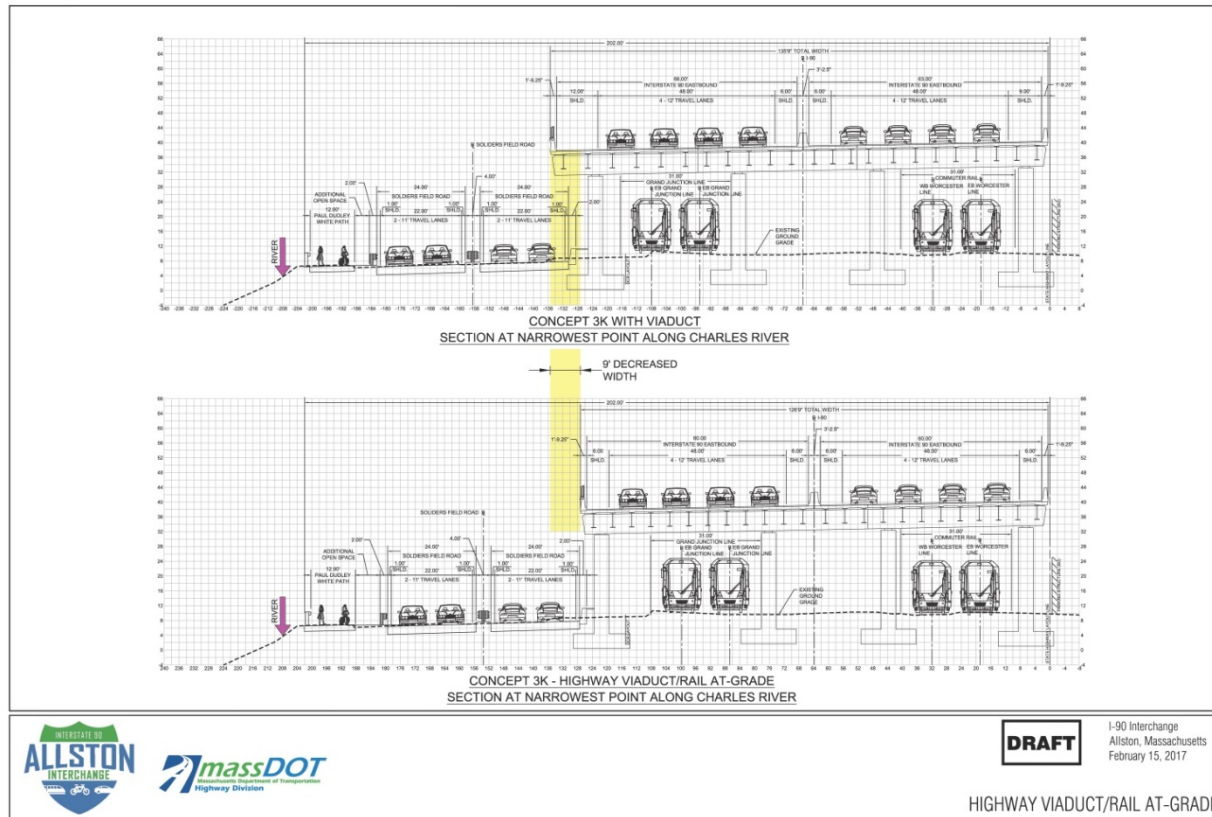

The above diagram displays one of the three alternatives MassDOT is currently considering for the “throat” section of the Allston I-90 Interchange Project. The throat refers to section of the project at its narrowest point between Harry Agganis Way and the BU Bridge. The above concept is referred to as “Concept 3K.” It is a refined version of Alternative 3K-4, the originally proposed MassDOT alternative. It elevates I-90, while keeping the Paul Dudley White Path, Solders Field Road, the Grand Junction Railroad and the MBTA Worcester Line at grade. Two variants are shown, one with 12 foot outside shoulders and 6 foot inside shoulders along I-90 and the other with 6 foot shoulders outside and inside. The reduction of outside shoulder width narrows the viaduct by 9 feet, thus slightly shifting Solders Field Road for additional park space along the Charles River.